

1. Steriles Sondenband aus der Verpackung entnehmen

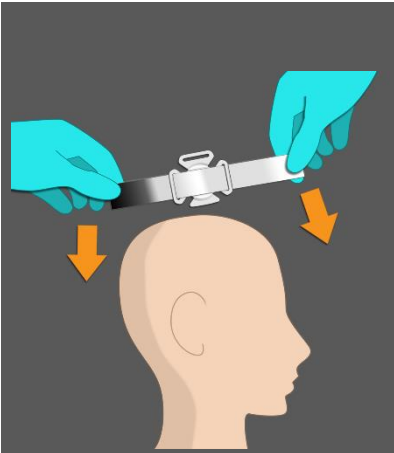

2. Sondenband auf Kopf platzieren

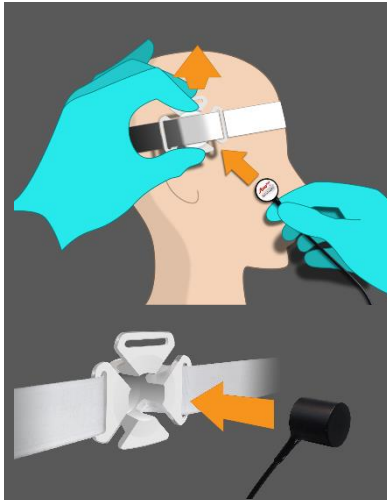

3. Sondenhalterung etwas anheben und die Ultraschallsonde von innen einsetzen. Das Kabel führt im 45°-Winkel aus der Halterung

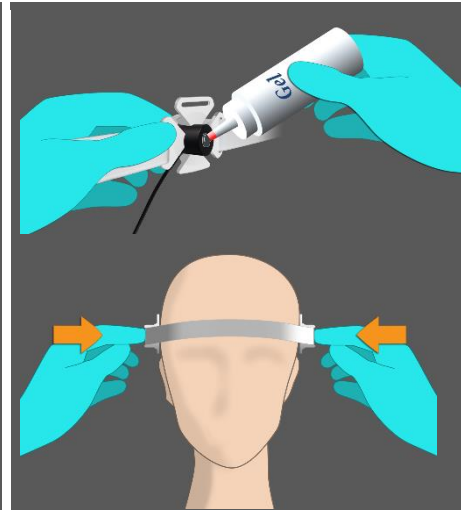

4. Beide Ultraschallsonden mit Ultraschallgel versehen und leicht andrücken

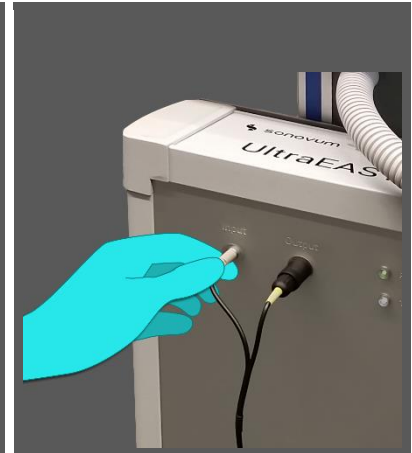

5. Stecker der Ultraschallsonden bis zum Einrasten in Gerät einstecken

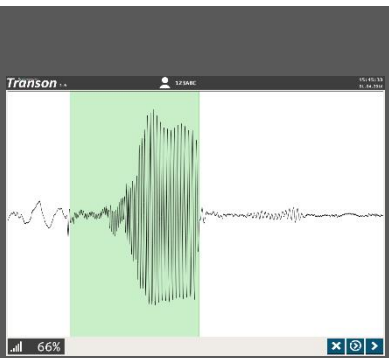

6. Signalinitialisierung

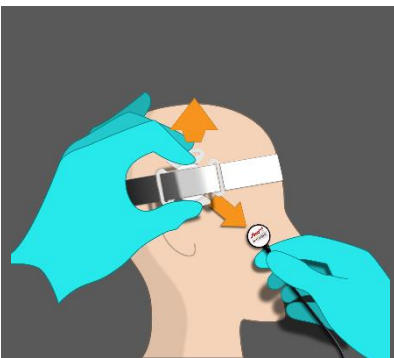

7. Ultraschallsonden nach durchgeführter Messung entfernen

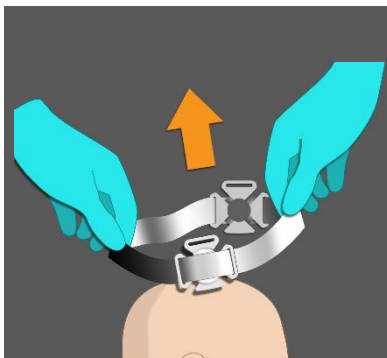

8. Sondenband abnehmen



9. Sondenband mit Sondenhalter werfen und Ultraschallsonden reinigen

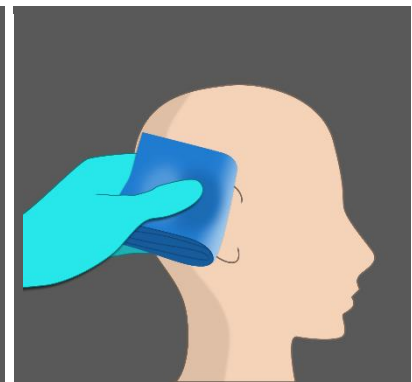

10. Messstellen reinigen

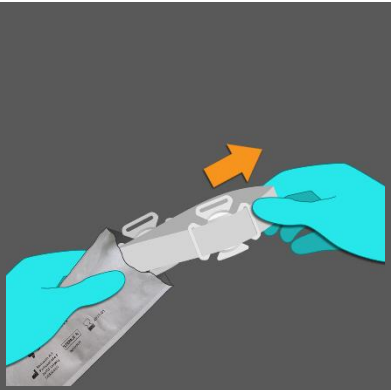

1. Take sterile headband from pouch

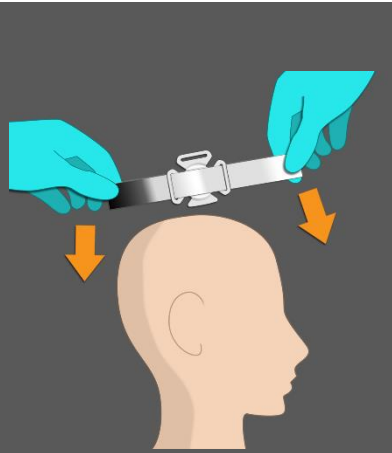

2. Place headband on patient's head

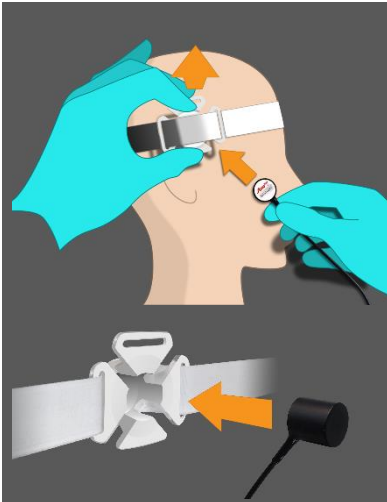

3. Lift headband slightly, insert probe with cable facing away from head; cable will protrude from probe holder in 45° angle

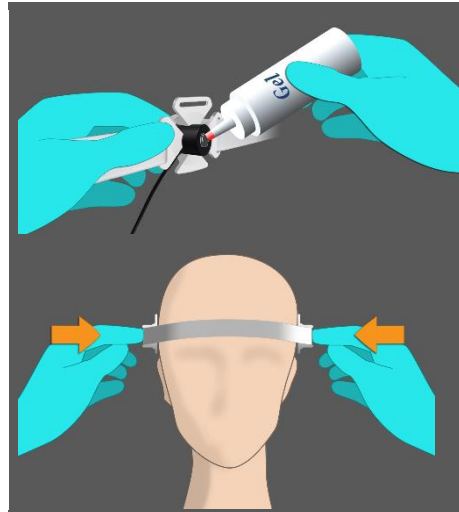

4. Cover front of probes with ultrasonic gel and apply light pressure on both of them

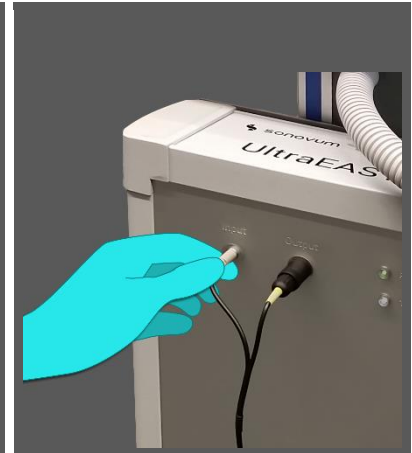

5. Insert two plugs into device until snap-in

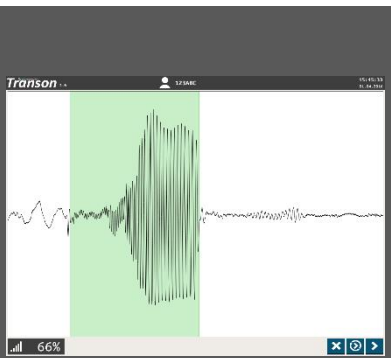

6. Wait for signal to initialise above 50%

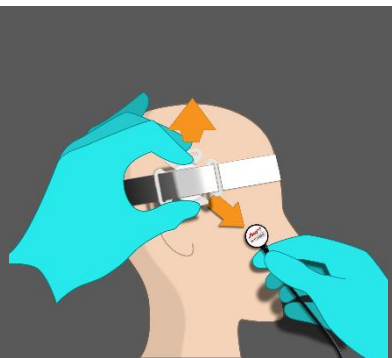

7. Remove probes after measurement

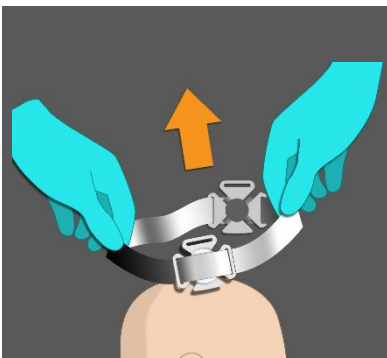

8. Remove headband



9. Dispose of headband and probe holders, clean probes of gel

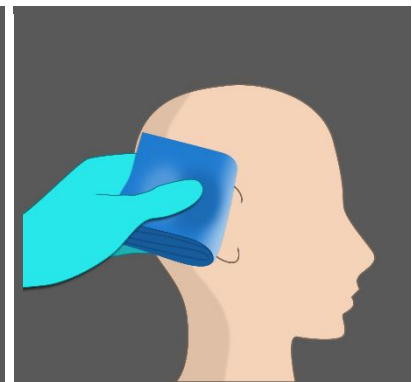

10. Wipe contact points on the skull